

9960 ZIP TRENCH®

DRAWING NUMBER
S9960

SIZE
A

SCALE:
NONE

DATE:
3-8-16

APPROVED BY:
PJ

CHECKED BY:
PJ

DRAWN BY:
TBW

9960

FIGURE NUMBER

WE CAN ASSUME NO RESPONSIBILITY FOR USE OF SUPERSEDED OR VOID DATA

DIMENSIONS ARE SUBJECT TO MANUFACTURERS TOLERANCE AND CHANGE WITHOUT NOTICE

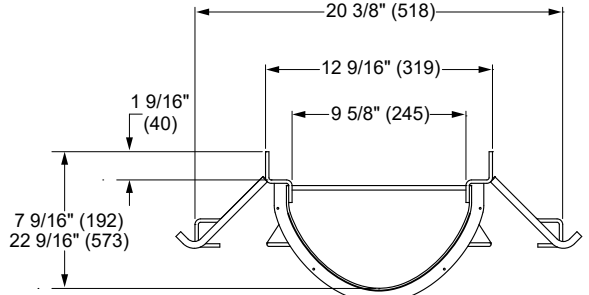
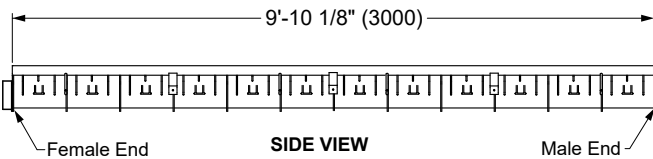
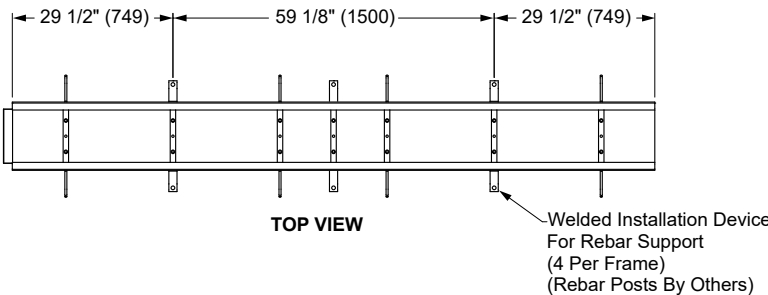
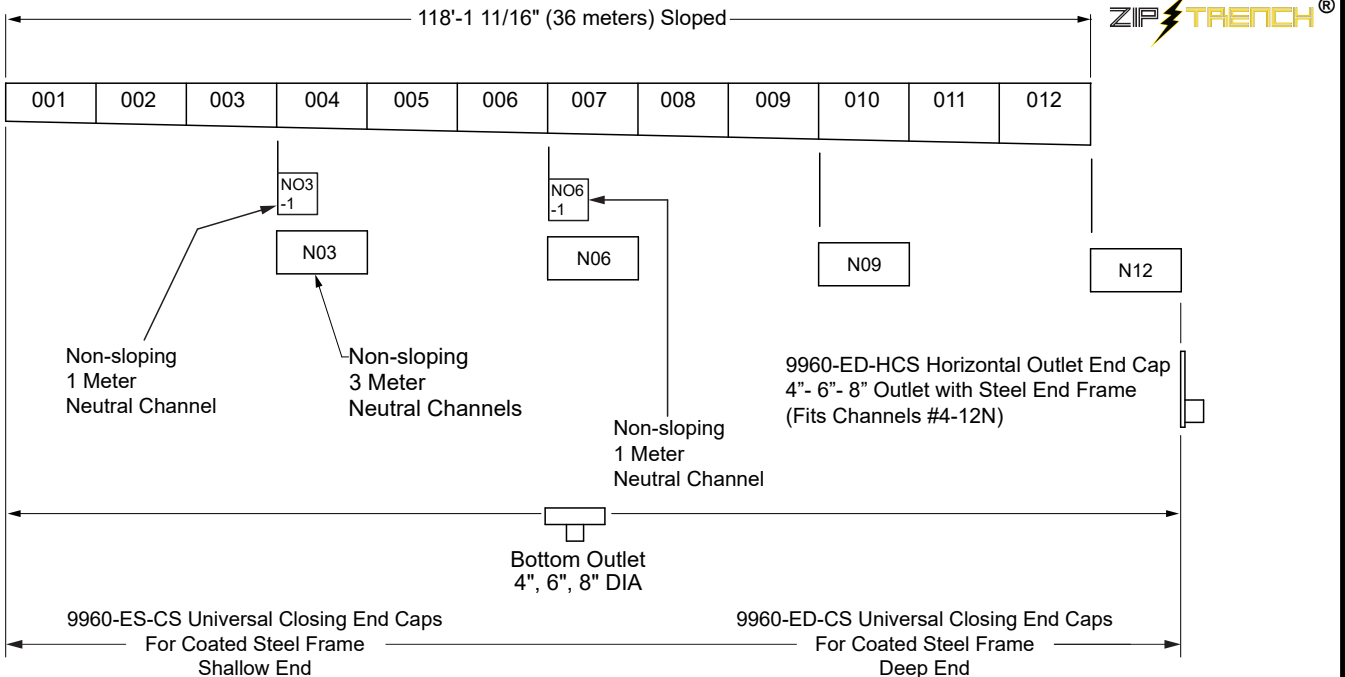

OPTIONAL RAIL MATERIAL:

- Galvanized Steel
- Type 304 Stainless Steel

Note: Dimensions in parentheses are in mm.
Note: See structural engineer drawings for rebar placement around the trench drain and concrete encasement requirements.
Note: See structural engineer drawings for expansion joint placement outside the trench drain concrete encasement.

REGULARLY FURNISHED:
 12 9/16" (319) wide, 3 meters (9.84') long, 100% Polypropylene Channel with UV Inhibitors and Coated Steel Frame. Channels connect with 2" Overlap Joint. Design has a Built In Slope of 1.07% with Radiused Bottom. Supplied with Secured Grate per Specification.

VARIATIONS:

- Grate Specifications (See Back)
- 9960-BO-004 4" Bottom Outlet F/9960
- 9960-BO-006 6" Bottom Outlet F/9960
- 9960-BO-008 8" Bottom Outlet F/9960
- 9960-ED-HCS 4" Horizontal End Cap w Steel Frame
- 9960-ED-HG 4" Horizontal End Cap w Galvanized Frame
- 9960-ED-HSS 4" Horizontal End Cap w Stainless Steel Frame
- 9960-ES-CS Shallow End Cap w Steel End Frame
- 9960-ES-G Shallow End Cap w Galvanized End Frame
- 9960-ES-SS Shallow End Cap w Stainless Steel End Frame
- 9960-FMC Female Coupling F/9960

REV.	DATE	DESCRIPTION	BY	CKD. BY	WEIGHT POUNDS	VOLUME CUBIC FEET	FIGURE NUMBER
							9960

9960 ZIP TRENCH®

Heavy Duty EN 1433 Load Class C:
56,000 lbs - 1,162 psi. For commercial pneumatic tire traffic patterns, forklifts (pneumatic tire) and tractor trailers (pneumatic tire).

- 9960-GM1G**-Galv. steel mesh grate (309.56 sq. in.) 1 meter
- 9960-GM.5G**-Galv. steel mesh grate (157.62 sq. in.) 1/2 meter
- 9960-GP1G**-Perforated galv. steel grate (78.00 sq. in.) 1 meter
- 9960-GP.5G**-Perforated galv. steel grate (39.00 sq. in.) 1/2 meter
- 9960-SSM1G**-Stainless steel mesh grate (309.56 sq. in.) 1 meter
- 9960-SSM.5G**-Stainless steel mesh grate (157.62 sq. in.) 1/2 meter
- 9960-SSP1G**-Perforated stainless steel grate (78.00 sq. in.) 1 meter
- 9960-SSP.5G**-Perforated stainless steel grate (39.00 sq. in.) 1/2 meter
- 9960-MC5G**-Ductile iron slotted grate (87.87 sq. in.) 1/2 meter
- 9960-MADAC.5G**-Ductile iron ADA slotted grate (58.00 sq. in.) 1/2 meter

- Extra Heavy Duty, EN 1433 Class E:**
135,000 lbs - 2,788 psi. For commercial solid tire traffic patterns, forklifts and impacts from steel struts or metal wheels.
- 9960-M.5G**-Ductile iron slotted grate (87.87 sq. in.) 1/2 meter
 - 9960-MADA.5G**-Ductile iron ADA slotted grate (58.00 sq. in.) 1/2 meter

HYDRAULIC CAPACITY AND DEEP END DEPTHS 9960 SYSTEM

Channel Number	Shallow End Invert		Slope	Deep End Invert		Slope	Single Channel		Weight Lbs.
	Inch	mm		Inch	mm		Est. CFS	Est. GPM	
9960-001	7.56	192	1.07%	8.81	224	1.07%	1.85	830	76.00
9960-002	8.81	224	1.07%	10.06	256	1.07%	2.68	1205	79.00
9960-003	10.06	256	1.07%	11.31	287	1.07%	3.13	1407	81.00
9960-N03-1	11.31	287	0.0%	11.31	287	0.0%	1.04	469	30.00
9960-N03	11.31	287	0.0%	11.31	287	0.0%	3.13	1407	81.00
9960-004	11.31	287	1.07%	12.56	319	1.07%	3.92	1760	83.00
9960-005	12.56	319	1.07%	13.81	351	1.07%	4.43	1990	86.00
9960-006	13.81	351	1.07%	15.06	383	1.07%	4.94	2220	89.00
9960-N06-1	15.06	383	0.0%	15.06	383	0.0%	1.65	740	31.00
9960-N06	15.06	383	0.0%	15.06	383	0.0%	4.94	2220	89.00
9960-007	15.06	383	1.07%	16.31	414	1.07%	5.46	2450	92.00
9960-008	16.31	414	1.07%	17.56	446	1.07%	5.97	2680	94.00
9960-009	17.56	446	1.07%	18.81	478	1.07%	6.48	2910	97.00
9960-N09	18.81	478	0.0%	18.81	478	0.0%	6.48	2910	97.00
9960-010	18.81	478	1.07%	20.06	510	1.07%	7.00	3140	99.00
9960-011	20.06	510	1.07%	21.31	541	1.07%	7.51	3370	103.00
9960-012	21.31	541	1.07%	22.56	573	1.07%	8.00	3600	106.00
9960-N12	22.56	573	0.0%	22.56	573	0.0%	8.00	3600	106.00

Note: Channel flow rates based on channels less grates and open ended.

DRAWING NUMBER: **S9960-BS**
 SIZE: **A**
 SCALE: **NONE**
 DATE: **3-8-16**
 APPROVED BY: **PJ**
 CHECKED BY: **PJ**
 DRAWN BY: **TBW**
9960-BS
 FIGURE NUMBER

WE CAN ASSUME NO RESPONSIBILITY FOR USE OF SUPERSEDED OR VOID DATA

DIMENSIONS ARE SUBJECT TO MANUFACTURERS TOLERANCE AND CHANGE WITHOUT NOTICE

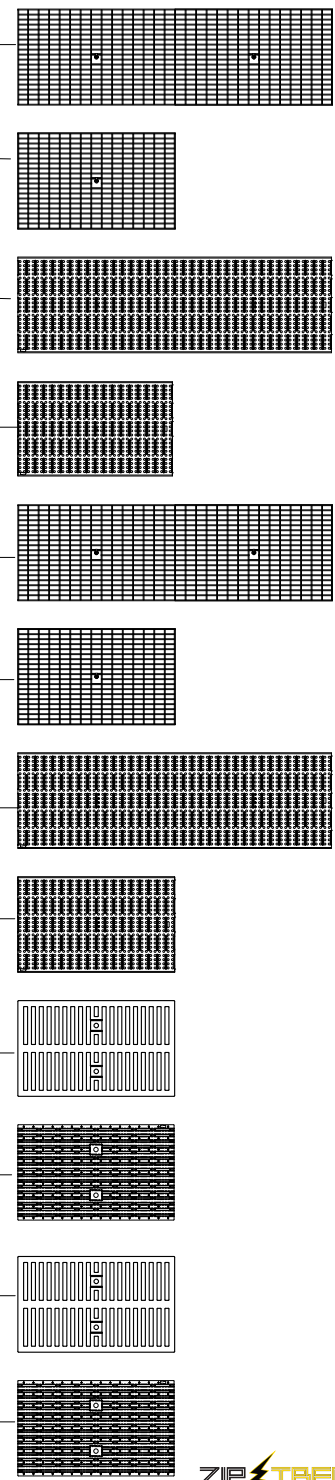

REV.	DATE	DESCRIPTION	BY	CKD. BY	WEIGHT POUNDS	VOLUME CUBIC FEET	FIGURE NUMBER
	6-23-26 6-3-24 7-22-22 1-28-21	Rev. Selections and Table Added @ Revised Table Revised Table	TB HS KK KK	KV CL PJ PJ			9960-BS